

**NOTES**

" THIS PLAN IS INTENDED TO COMPLY WITH THE REQUIREMENTS OF THE LICENSING (SCOTLAND) ACT 2005 AND IN PARTICULAR THE PREMISES LICENSE (SCOTLAND) REGULATIONS 2007 , S12007/452 .

ANY ADDITIONAL INFORMATION PROVIDED ON THESE PLANS OUTWITH THAT WHICH IS REQUIRED IN RESPECT OF THE LEGISLATION AND REGULATIONS REFERRED TO IS FOR INFORMATION ONLY AND SHOULD NOT BE TAKEN TO FORM PART OF THE LAYOUT PLAN FOR ANY OTHER PURPOSE .

CHILDREN AND YOUNG PERSONS HAVE ACCESS TO ALL PUBLIC PARTS OF THESE PREMISES .

ALL ACTIVITIES DETAILED AT QUESTION 5 OF THE OPERATING PLAN PERTAINING TO THESE PREMISES WILL TAKE PLACE IN THE PUBLIC AREAS OF THE PREMISES , WITH THE EXCEPTION OF RECORDED MUSIC (SPAR RADIO) WHICH WILL BE PLAYED AND AUDIBLE THROUGHOUT THE SHOP PREMISES . "

SHELVING DISPLAY		
Shelf unit	Width (metres)	Height (metres)
1	6.25	2.00
2	1.00	2.00
3	6.25	2.00
4	1.00	2.00
BEHIND COUNTER		
Shelf unit	Width (metres)	Height (metres)
5	0.65	2.00
6	0.65	2.00
7	1.00	2.00
STACKED DISPLAY		
Shelf unit	Width (metres)	Height (metres)
8	0.53	1.50
9	0.53	1.50
10	0.53	1.50
11	0.53	1.50
<b>TOTAL DISPLAY CAPACITY</b>	<b>36.80</b>	

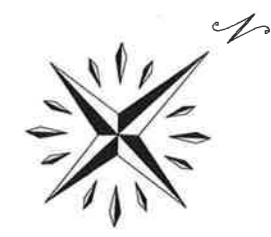
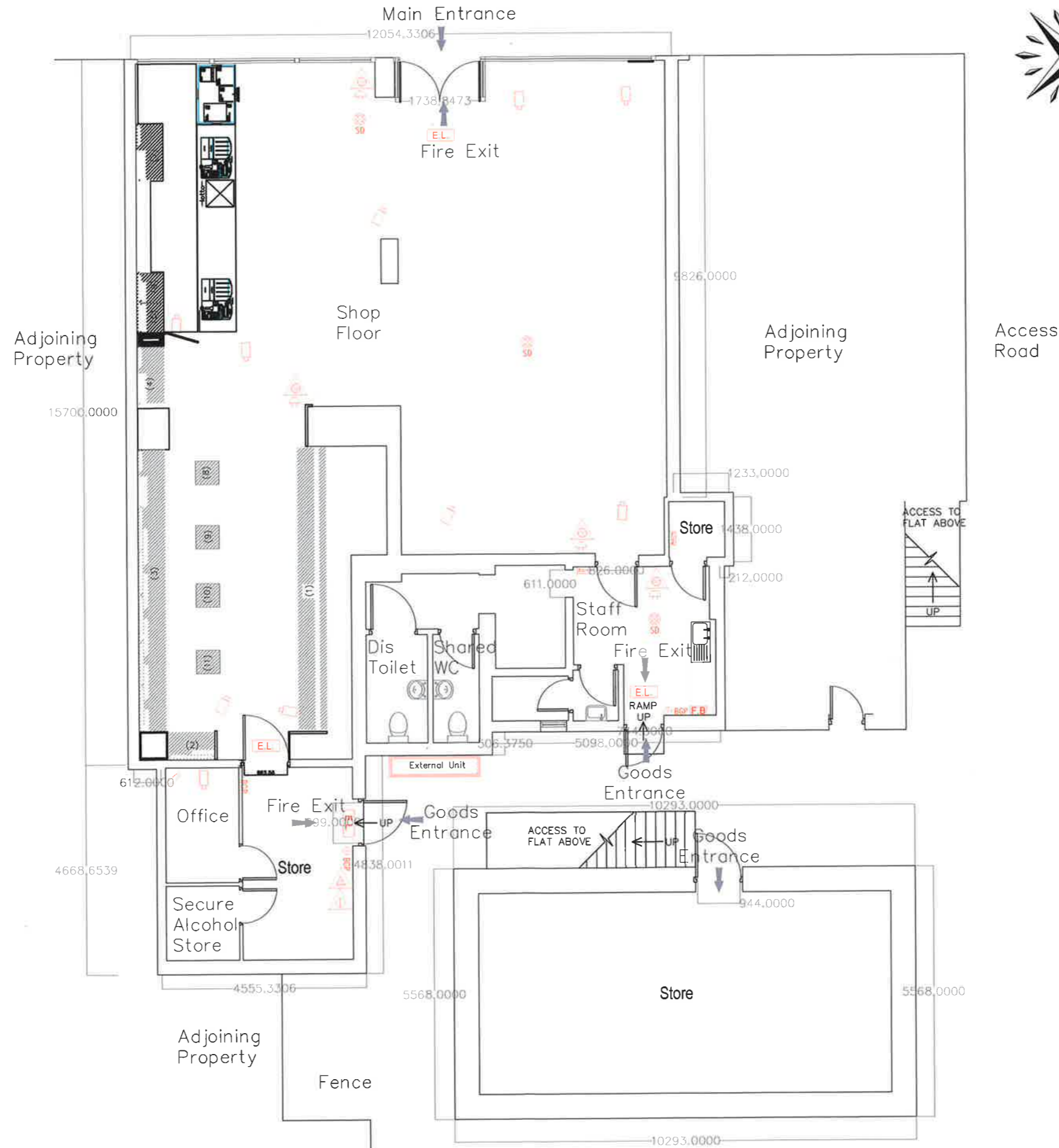

THE CONTENTS OF THIS PROPOSAL, INCLUDING ALL IDEAS, DRAWINGS, ARTWORK, GRAPHICS & LAYOUTS ARE THE PROPERTY OF CJ LANG PROPERTY DEPARTMENT. ALL INFORMATION AND OTHER INTELLECTUAL PROPERTY RIGHTS FORMING ANY PART OF THIS PROPOSAL SHOULD NOT BE USED BY ANY PERSON, INCLUDING THE CLIENT, WITHOUT THE PRIOR WRITTEN CONSENT OF CJ LANG & SON LTD SCOTLAND. THE CONTRACTOR TO CHECK DIMENSIONS AND NOTIFY ANY DISCREPANCIES OR ERRORS IMMEDIATELY TO CJ LANG & SON LTD SCOTLAND.

- LEGEND**
- Alarm Control Panel
  - Break glass call point
  - CCTV Camera
  - CCTV Eye
  - CCTV Monitor
  - Clock in
  - Emergency Lights
  - Fire Exit sign
  - Fire Extinguisher FOAM
  - Fire Extinguisher DRY POWDER
  - Fire Extinguisher CO2
  - Fire Extinguisher WATER
  - Media Screen
  - Sounder
  - Smoke detector

REV	DATE	INIT	COMMENT
Project: TROON 12 Portland Street, Troon, Ayrshire, KA10 8EA			
Title: Licensing Layout			
Drawing No: 08 462 3500			
Scale: 1:100@A3	Date: 17.06.14	Area: 08	Store No: 462
Drawn by: NM	Checked by: JR	Rev:	



Head Office  
78 Longtown Road  
Dundee  
DD4 8JU  
Phone : 01382 512 000  
Fax : 01382 508 222

**LICENSING (SCOTLAND) ACT 2000 LAYOUT PLAN  
1:100**